

SECTION 6:

- CHUTE ASSEMBLIES

- CHUTE PUMP

- FEED HOPPERS

- SWIVEL CHUTES

	PART NO.	DESCRIPTION	Weight and Dimensions	QR Code
	034-502758	CYLINDER-3"- D-ACTING RAM -C/W VALVE	13.4KG	
	065-501622	KIT-HYD HOSE - SUIT 3in RAM		
	034-502732	Extension Light Weight Liner - 5mm		
	034-508308	Extension Light Weight Frame (Primed or Painted)		
	034-508428	Extension Light Weight Complete Chute Assembly (Primed or Painted)		
	034-502731	Placement Light Weight Liner		
	034-508309	Full Placement Light Weight Frame (Primed or Painted)		
	034-508429	Full Placement Light Weight Complete Chute Assembly - Placement-LWT		

	PART NO.	DESCRIPTION
	034-502736	Half Placement Light Weight Liner
	034-508454	Half Placement Light Weight Frame (Primed or Painted)
	034-508427	Half Placement Light Weight Complete Chute Assembly
	034-706119	Extension Liner – Forbes - suit – ATT/Mixers Aust.
	032-708404	Extension Chute Frame Only – Forbes - suit – ATT/Mixers Aust.
	032-708418	Extension Chute Complete Chute Assembly – Forbes - suit – ATT/Mixers Aust.
	034-706126	Placement Liner – Forbes - suit – ATT/Mixers Aust.
	033-708407	Placement Chute Frame – Forbes - suit – ATT/Mixers Aust.
	033-708417	Placement Chute -Complete Chute Assembly – Forbes - suit – ATT/Mixers Aust.

	PART NO.	DESCRIPTION
	034-502748	Extension Poly Liner - 5mm
	032-508416	Extension Aluminum Light Weight Frame (Primed or Painted)
	032-510703	Aluminum Extension Frame & Poly Liner - FULL CHUTE ASSEMBLY Cesco
	034-502747	1/2 Placement Poly Liner - 5mm
	033-508415	1/2 Placement Aluminum Light Weight Frame (Primed or Painted)
	033-510705	Aluminum 1/2 Placement Frame & Poly Liner - FULL CHUTE ASSEMBLY Cesco
	034-TBA	Full Placement Poly Liner - 5mm
	033-508418	Full Placement Light Weight Frame (Primed or Painted)
	033-510704	Aluminum Full Placement Frame & Poly Liner - FULL CHUTE ASSEMBLY Cesco

	PART NO.	DESCRIPTION
	032-510700	CHUTE-FULL ALUMINUM EXTENSION CHUTE
	033-510701	CHUTE-FULL ALUMINUM PLACEMENT CHUTE
	033-510702	CHUTE-FULL ALUMINUM 1/2 PLACEMENT CHUTE Cesco
	034-506195A	Extension Chute Liner (complete with aluminum strip) and rivets – Old Style Cesco
	034-508465	Extension Chute Poly (Frame only)
	032-508466	Old Style Extension Chute Poly Complete (Available Primed or Painted.) Cesco
	034-508462	Placement Chute Poly Frame only (Painted)
	033-508463	Old Style Placement Chute Poly Complete (Painted) (Available Primed or Painted.) Cesco

	PART NO.	DESCRIPTION		
	030-508439	Hopper - Feed Chute (Round) Cesco – (also suit ATT/MIXERS AUST)		
	030-508414	Hopper - Feed Chute (Square) Cesco – (also suit ATT/MIXERS AUST)		
	030-508451	Hopper – Large Round Feed Chute – Export Hopper - CESCO		
	030-708412	Hopper – Feed Chute (Round) Forbes – suit ATT/MIXERS AUST Available Primed or Painted		
	034-504750	Manual Control Valve – Double Acting Ram	N/A	
	065-38OP10H	Handle for Manual Control Valve	N/A	
	065-38OP10LB	Lever Box for Manual Control Valve	N/A	

MANUAL CHUTE PUMP – MAXI - 330MM STROKE

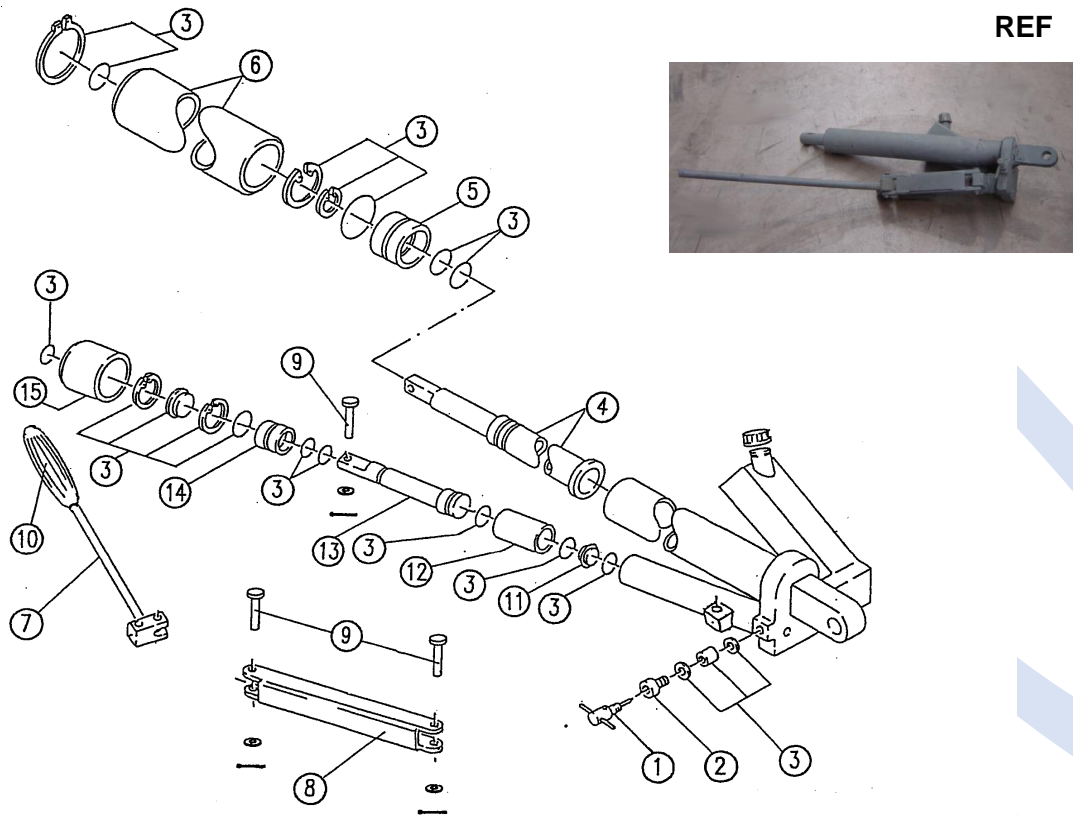

ITEM	PART NO	DESCRIPTION	
REF	034-502038	CHUTE PUMP COMPLETE MAXI	
	034-502055	CHUTE PUMP COMPLETE MINI	Cesco
1	034-501502	RELEASE VALVE	
2	034-501503	GLAND BUSH	
3	034-501511	REPAIR KIT	
4	034-501538	RAM PISTON MAXI	
	034-501554	RAM PISTON MINI	Cesco
5	034-501537	RAM SHAFT SLEEVE	
6	034-501539	RAM OUTER COVER MAXI	
	034-501555	RAM OUTER COVER MINI	Cesco
7	034-501580	PUMP HANDLE	
8	034-501581	TRANSFER LEVER	
9	034-501582	CLEVIS PIN SET	
10	034-501583	RUBBER HAND GRIP	
11	034-501541	PISTON TUBE ADAPTOR	
12	034-501546	PISTON TUBE	
13	034-501542	PISTON	
14	034-501547	PUMP SLEEVE	
15	034-501543	PUMP OUTER COVER	

ALL ITEMS COMMON TO CESCO & FORBES, UNLESS NOTED.

SWIVEL CHUTES

	PART NO.	DESCRIPTION
	031-508401	SWIVEL CHUTE-CESCO- 4MM - LONG (*WITH UNIQUE LONG SAFETY HANDLES EACH SIDE) Available Primed or Painted
	031-708411	Swivel Chute – Short – suit ATT/Mixers Aust.
	031-708419	SWIVEL CHUTE – LONG – suit ATT/Mixers Aust. Forbes - (*ALSO MADE WITH UNIQUE LONG SAFETY HANDLES EACH SIDE) Available Primed or Painted
	034-506119	Swivel Chute Pin
	034-502052	CHUTE PIN NIPPLE. GREASE - 1/8 BSP Cesco & Forbes
	034-506199	Flexi-strap (finger) Hook

	PART NO.	DESCRIPTION
	<p>034-502752</p> <p>034-502753</p>	<p>Flexi-strap Short (24")</p> <p>Flexi-strap Long (31")</p>
	<p>080-508445</p> <p>034-506178</p>	<p>Swivel Chute Flap Kit</p> <p>Flap Rubber ONLY</p>
	<p>022-508400</p>	<p>Chute Scraper</p>
	<p>065-501360</p>	<p>CHUTE RAM NIPPLES-ADAPTOR. 9/16UNOx9/16JIC</p>
	<p>022-501042</p>	<p>Bridge-Removable Inlet – (Hopper Mounting Plate)</p>